

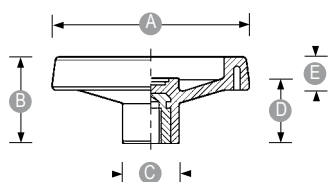

(ES) Volantes | (EN) Handwheels | (FR) Volants | (PT) Volantes



Volante 2 radios
2 Spoke Control Handwheel
Volant à 2 rayons
Volantes de 2 raios

Material: Termoplástico reforzado acabado mate
Material: High impact resistant thermoplastic, matt finish
Matière: Thermoplastique renforcé surface mate
Material: Termoplástico reforçado acabamento mate

Material del núcleo: Acero cincado
Insert material: Zinc plated steel
Insert: Taraudage borgne en acier zingué
Material do inserto: Aço zincado

Color: Negro (volante) / Gris (tapa central)
Colour: Black (handwheel) / Grey (central cap)
Couleur: Noire (Volant) / Gris (Bouchon central)
Cor: Preto (volante) / Cinzento (tampa central)

(ES) (EN) (FR) (PT)

P Gama preferida
Preferred range
Gamme préférence
Gama preferida

Gama estándar
Standard rage
Gamme standard
Gama padrão

Sujeto a cantidades mínimas (unidades)
Minimum order quantity (pieces)
Quantités minimum (unités)
Sujeito a quantidades mínimas (unidades)

Ø H10 Agujero guía (tolerancia H10)

Pilot bore (H10 tolerance)
Diamètre de l'alsage (tolérance H10)
Furo guia (tolerância H10)

Ø max Agujero máximo

Maximum bore
Diamètre maximum réalisable
Furo máximo

	Ref.		A	B	C	D	E	Ø H10	Ø max
	R91-80	●	80	34,0	24,5	26,0	14,0	5	12
P	R91-100	●	99	43,0	28,0	33,0	16,5	5	16
P	R91-130	●	129	50,0	32,0	36,0	18,0	5	18
P	R91-160	●	159	57,0	40,0	40,5	23,0	8	22
P	R91-200	●	198	61,5	51,0	39,5	28,5	8	22
P	R91-250	●	252	70,0	55,5	47,0	31,0	8	28
	R91-350	●	346	80,0	67,5	49,5	36,5	8	30

